

## Atharva Apeksha-Boisar



### Project Details

#### ***Your Space Your Home***

***As you step in to Atharva Apeksha Complex you will find yourself walking down the path of Prosperity, Vastu and Comfort.***

Get on top of life with the large and lanky balconies at atharva apeksha complex. View the perfectly manicured lawns below and let a feeling of freshness take you over. A gateway for cool breeze and health to flow in to your home, these balconies are a perfect vantage point from where you can watch the carefree children playing in the park while life goes on and leaves behind a trail of happy memories.

***A symphony of natural and enthralling environment with aesthetic designs.***

### Amenities

#### **Electrical**

Heavy duty copper wire in entire flat with adequate points with high quality modular switches.

Telephone and T.V Points in the living and bedrooms.

#### **Toilet**

Full tiles on flooring and wall in w.c and bath up to beam level and geyser in bathroom

Concealed plumbing and high quality brass fittings and fixtures.

Branded sanitary ware of good quality

## Painting

POP finished with good quality distemper paint in entire flat.

Decorative pop moulding in the ceiling will be provided in the living room.

The exterior of the building will be painted with good quality acrylic brabded paint.

## Flooring

Elegant high quality vitrified tiles along with skirting in the entire flat.

## Window

Poweder coating aluminium sliding window with onw way mirroe glass with marble / granite sill.

## Door

Decorative laminated main flush door with high quality brass fitting.

## Kitchen

Granite kitchen platform with stainless steel sink and titles up to beam level dado above platform.

## LAYOUT PLAN

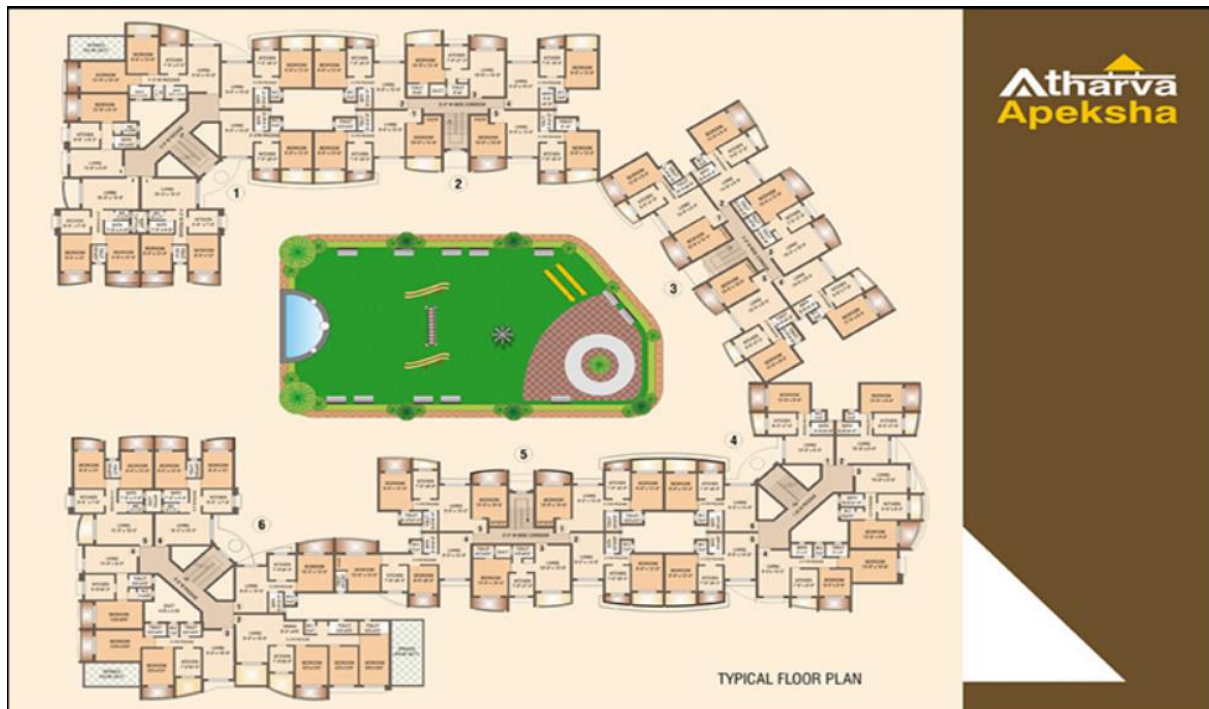

## LOCATION MAP

