

## Vasudev Chambers

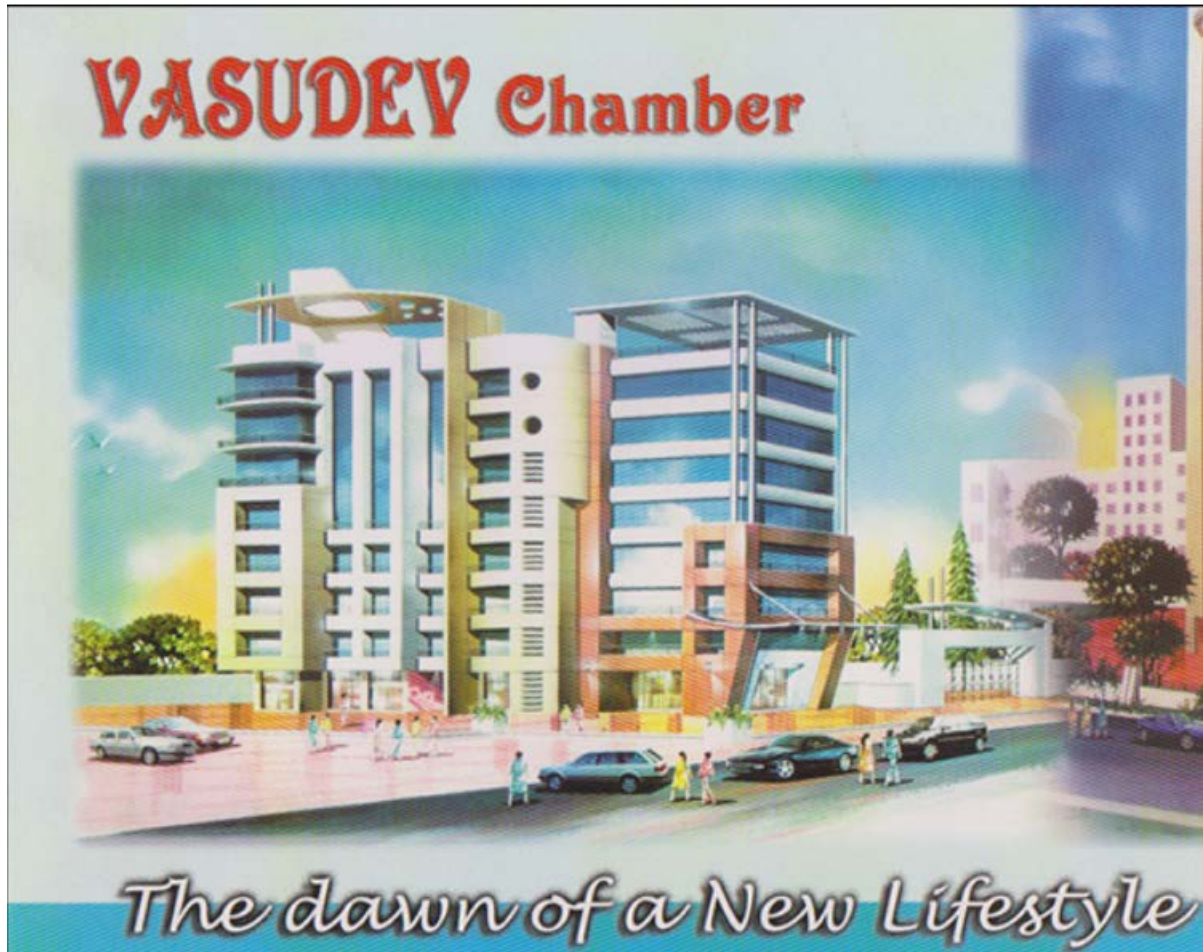

### Amenities

**Structure:** good quality R.C.C Structure.

**Appearance:** eye appealing elevation with maximum cross ventilation.

**Security:** Boundary walls around the building with highly professional security guards for security.

**Flooring:** granite/granamite/ultra modern tiles/flooring in bedroom,kitchen& hall.

**Kitchen:** granite kitchen platform with stainless steel sink.

**Bathroom:** full decorative ceramic tiles in bathroom.

**Plumbing:** concealed plumbing work with good quality of C.P Fitting.

**Windows:** marble frames in toilet , bathroom 7 windows.

**Sliding:** ¾ Aluminium section powder coated sliding with tinted glass windows.

**Wiring:** concealed copper wiring with adequate points in hall, kitchen & bathroom with modular switches.

**Walls:** internal walls shall be finished with pop & sistemper paints.

**Door:** decorative polished entrance door with superior quality fitting.

**Lift:** ultra modern lift with decorative case.

**Playground:** playground / garden for children with lot of open space around the building.

**Entrance:** entrance lobby at ground floor will be designed & decorative laid with granite / marble etc.

### LAYOUT PLAN

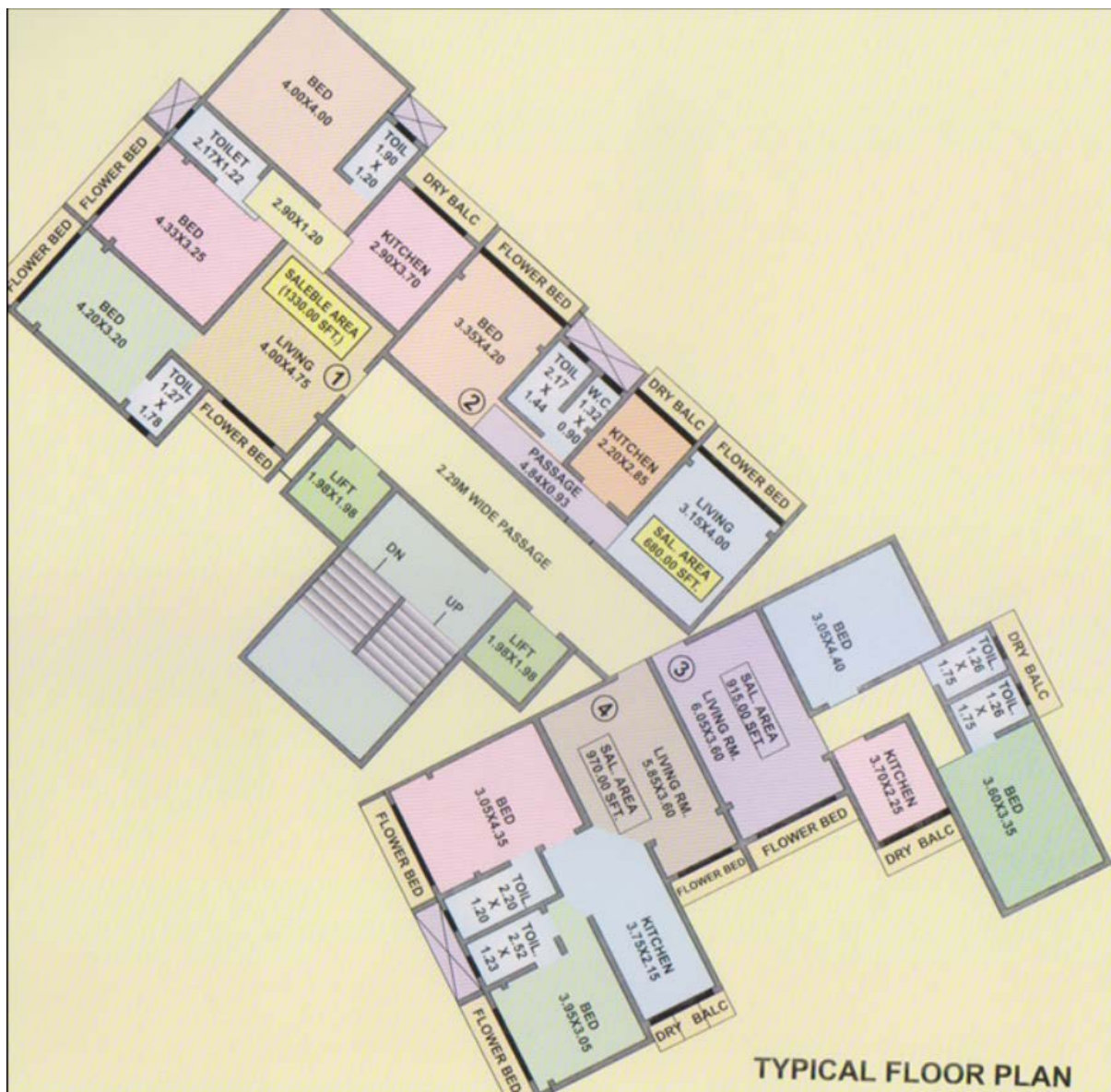

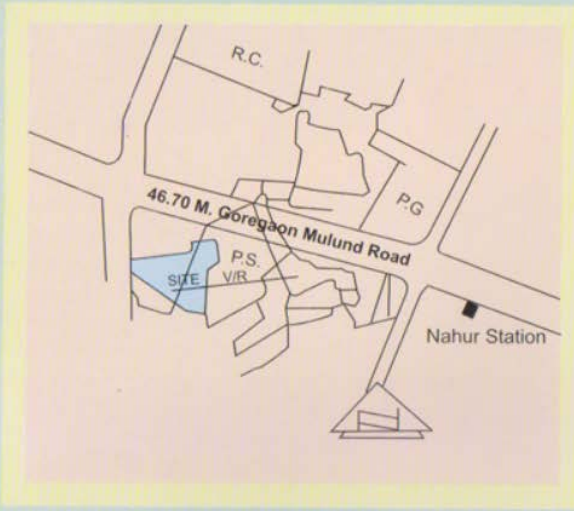

**LOCATION PLAN**

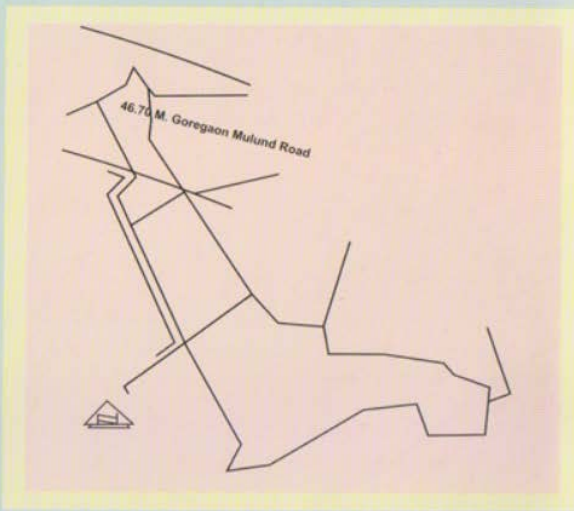

**BLOCK PLAN**